

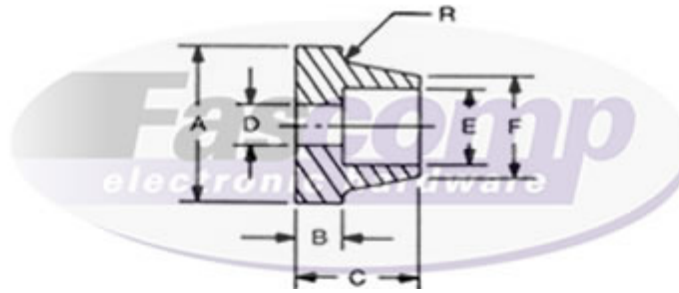

# Ferrules Type 3



Create a part number:		
Length	Material	Finish
FCXXXX	XX	XX
_____ - _____ - _____		

Part Number							
✓	FCXXXX	A +.005 -.005	B +.005 -.005	C +.005 -.005	D +.005 -.005	E +.005 -.005	F +.015 -.015
	FC8991	5/8	.062	.375	.201	.257	21/64
	FC8992	3/4	.062	.375	.201	.322	25/64
	FC8993	3/4	.062	.375	.201	.383	29/64

Material	
✓	Material Code (XX)
	A Aluminum
	B Brass
	S Steel
	SS Stainless Steel

Compatible Finish	
A, B, S, SS	0 - Plain
B, S	5 - Nickel Plate (QQ-N-290)
A	6 - Iridite #14 Gold (MIL-C-5541E)
A	7 - Iridite Clear (MIL-C-5541E)
A	9 - Alodine 1200
B, S	12 - Zinc Clear (ASTM-B-633)
B, S	16 - Electro Tin (MIL-T-10727 TYPE 1)
SS	20 - Passivation (MIL-F-14072D)
A	22 - Clear Anodize (MIL-A-8625-TYPE2) (Sulphuric) Hot Water Seal (Clear)
A	24 - Black Anodize (MIL-A-8625)
B, S, SS	26 - Black Oxide
B, S	28 - Zinc Yellow (ASTM-B-633)

**Tolerances  
Unless otherwise Specified**  
 .xxx +/- .005  
 .xx +/- .010  
 Angular +/- 1 Degree  
 Linear +/- .005  
**Break all sharp edges**



Source Control Drawing:  
To be produced by  
Fascomp Electronic Hardware

This document is the property of Fascomp Inc. and shall not be reproduced, distributed or used as a basis for manufacturing without written permission from Fascomp Inc.